



F300



HSS Adjustable Split Hand Die, Metric, Right Hand

Split die to produce external thread by hand in multiple passes, adjusting each pass. By tightening the die stock holder, different classes of thread fit can be achieved - tight, regular or loose fit. Slightly tightened in the holder, it can be used to clean up or produce a partial thread.

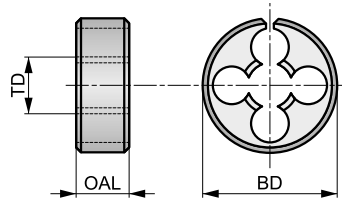

M	BS 1127:1950	1.75 XP
HSS	R	Bright

Workpiece material group suitability and starting values for cutting speed (m/min).

P1.1 ■ 12	P1.2 ■ 13	P1.3 ■ 14	P2.1 ■ 10	P2.2 ■ 9	P2.3 ▣ 8	P3.1 ■ 8	P3.2 ▣ 7	P4.1 ▣ 5	M1.1 ■ 7	M1.2 ■ 6	M2.1 ■ 6	M2.2 ▣ 5	K1.1 ■ 11
K1.2 ■ 8	K1.3 ▣ 6	K2.1 ■ 11	K2.2 ■ 9	K2.3 ▣ 7	K3.1 ■ 10	K3.2 ■ 8	K3.3 ▣ 6	K5.1 ■ 10	K5.2 ■ 8	K5.3 ▣ 6	N1.1 ▣ 20	N1.2 ▣ 15	N1.3 ▣ 10
N2.1 ▣ 10	N2.2 ▣ 9	N2.3 ▣ 6	N3.1 ■ 11	N3.2 ▣ 6	N3.3 ▣ 3	N4.1 ▣ 11	N4.2 ▣ 4	N4.3 ▣ 4					

Products from this series are also available in set with taps. Please see L120.

Product	TD [mm]	TP [mm]	BD [inch]	OAL [inch]
F300M2X13/16	2.000	0.40	13/16	1/4
F300M2.5X13/16	2.500	0.45	13/16	1/4
F300M3X13/16	3.000	0.50	13/16	1/4
F300M3.5X13/16	3.500	0.60	13/16	1/4
F300M4X13/16	4.000	0.70	13/16	1/4
F300M5X13/16	5.000	0.80	13/16	1/4
F300M5X1	5.000	0.80	1"	3/8
F300M6X13/16	6.000	1.00	13/16	1/4
F300M6X1	6.000	1.00	1"	3/8
F300M6X1.5/16	6.000	1.00	1.5/16	7/16
F300M7X13/16	7.000	1.00	13/16	1/4
F300M7X1	7.000	1.00	1"	3/8
F300M8X1	8.000	1.25	1"	3/8
F300M8X1.5/16	8.000	1.25	1.5/16	7/16
F300M9X1	9.000	1.25	1"	3/8
F300M9X1.5/16	9.000	1.25	1.5/16	7/16
F300M10X1	10.000	1.50	1"	3/8
F300M10X1.5/16	10.000	1.50	1.5/16	7/16

Product	TD [mm]	TP [mm]	BD [inch]	OAL [inch]
F300M10X1.1/2	10.000	1.50	1.1/2	1/2
F300M11X1.5/16	11.000	1.50	1.5/16	7/16
F300M12X1.5/16	12.000	1.75	1.5/16	7/16
F300M12X1.1/2	12.000	1.75	1.1/2	1/2
F300M14X1.5/16	14.000	2.00	1.5/16	7/16
F300M14X1.1/2	14.000	2.00	1.1/2	1/2
F300M16X1.1/2	16.000	2.00	1.1/2	1/2
F300M16X2	16.000	2.00	2"	5/8
F300M18X1.1/2	18.000	2.50	1.1/2	1/2
F300M18X2	18.000	2.50	2"	5/8
F300M20X1.1/2	20.000	2.50	1.1/2	1/2
F300M20X2	20.000	2.50	2"	5/8
F300M22X2	22.000	2.50	2"	5/8
F300M24X2	24.000	3.00	2"	5/8
F300M27X3	27.000	3.00	3"	7/8
F300M30X3	30.000	3.50	3"	7/8
F300M36X3	36.000	4.00	3"	7/8